

GTG-71/GTG-62 Drawer

Compact silicone keyboard, 71 or 62 keys, with drawer.



Description



- The proven technique of the GTG-71 or the GTG-62 keyboard is offered in a durable drawer for example for 19 " devices.

The distinguishing feature of the versions GTG-71 and GTG-62 is the keyboard layout. Please also see the data sheets " GTG-71 silicone switching mat " and "GTG-62 silicone switching mat " in the catalog cross reference.

The GTG-62 is additionally available as version with RS232 interface.

You find the description of the general advantages of the GTG-71 and the GTG-62 series under the catalog cross references down.

-
- Drawer for front panel
- This version of the GTG-71 or GTG-62 is built into a durable metal drawer - complete with integrated controller.

The drawer can easily be installed behind a rectangular opening in any front panel. The keyboard needs only little space because it has an extremely flatt 1 HE profile and compact masses.

If you pull out the keyboard, it folds down a bit, whereby it is to be served more easily. Two screws serve for locking, when the drawer is closed.

-

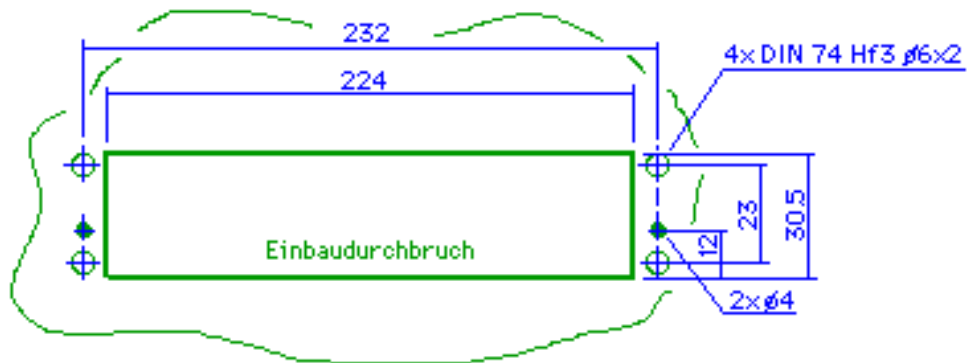
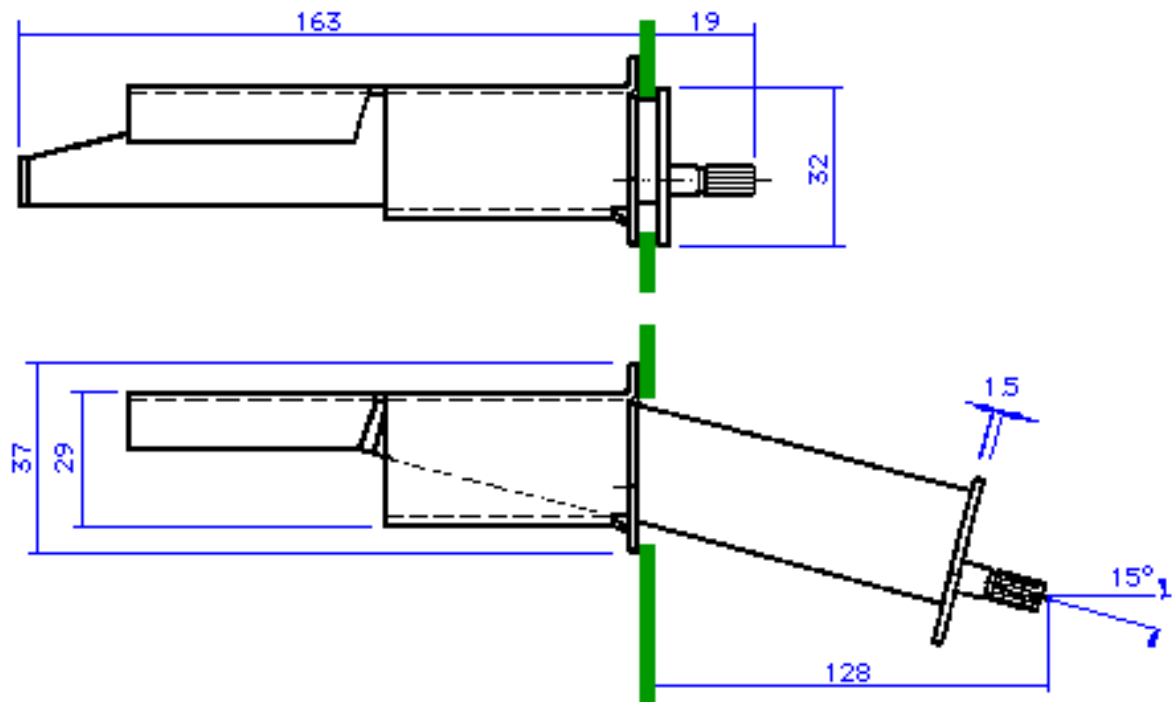

Specification**Mechanical data**

Dimensions:	243,5 x 163 x 37,5 mm
Weight:	1,1 kg
Housing:	Metal
Degree of Protection:	IP65
Cable Length:	85 cm

Keys

Key Technology:	conductiv rubber
Number of Keys:	62 & 71
Keyboard Layout:	MF2-German
Operational Life:	5 mio. keystrokes min.
Actuation Force:	1,3 N
Stroke Travel:	1,2 mm
Key Legend:	silk screen

Electric Data

Interface:	RS232
Operating Voltage:	5 V
Operating Current:	110 mA

Environment

Operating Temperature:	from -10 °C to °C or to +60 °C
Storage Temperature:	from -20 °C to +80 °C

Order Information

Order No.	Article	
71 keys		
KM1181	GTG-71-SCHUB-PS/2-GER	AT interfaces, US layout
KM1103	GTG-71-SCHUB-PS/2-US	AT interfaces, US layout
62 keys		
KM1130	GTG-62-SCHUB-PS2-GER	PS/2 interfaces, German layout
KM1133	GTG-62-SCHUB-PS2-US	PS/2 interfaces, US layout
KM1024	GTG-62-SCHUB-RS232-GER	RS232 interfaces, German layout
KM1025	GTG-62-SCHUB-RS232-US	RS232 interfaces, US layout

Accessories

Order No.	Article
-----------	---------

ZK1029	COM 9255	adapter PS/2 to AT
		

Links

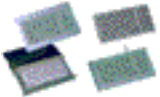
Click!	Titel
	GTG-71/GTG-62 Series Silicone mat keyboard with 71 or 62 keys in many different designs

sales@www.tastaturen.com Anrufen: (0 89) 89 43 99-0 Faxen: (0 89) 89 43 99-11